



# APPLIED ENGINEERING PRODUCTS

(203) 776-2813 FAX (203) 776-8294

www.aepconnectors.com

## Assembly Instructions

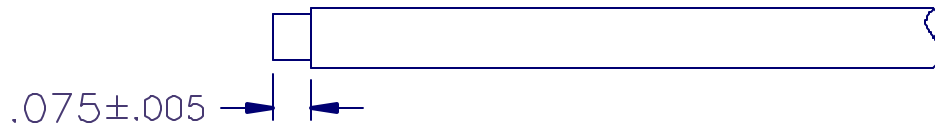

1. TRIM CABLE JACKET ONLY, AS SHOWN.

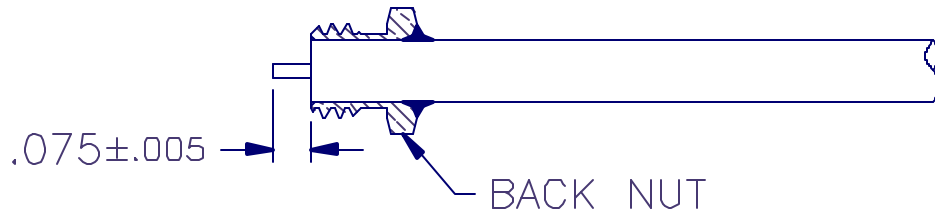

2. SLIDE BACK NUT ONTO CABLE UNTIL TRIMMED END OF JACKET IS FLUSH WITH FRONT OF NUT. SOLDER NUT TO CABLE.
3. TRIM DIELECTRIC AS SHOWN.

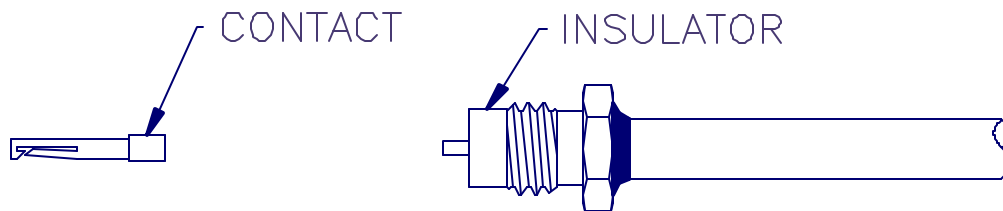

4. INSTALL INSULATOR OVER CABLE CENTER CONDUCTOR.
5. SOLDER CONTACT TO CENTER CONDUCTOR.
6. INSERT CABLE ASSEMBLY INTO CONNECTOR BODY AND TIGHTEN TO 35-45 INCH OUNCES TORQUE.

AIS-233-B125

REV. A

4138